

# FANUC Robot M-420iA/421iA



## 特点

- 这是一款为物流系统的机器人化做出贡献的物流智能机器人。
- 可根据系统布局，选择最佳的轴配置类型。  
FANUC Robot M-420iA : 4轴型  
FANUC Robot M-421iA : 2轴型
- 具有最大3,000次/小时的搬运能力。通过活用最大50kg的可搬运能力，一次取出多个产品，从而提高搬运作业效率。
- M-420iA/M-421iA是由搭载了多种智能化功能的最新式的高性能控制器R-J3iC控制的。

## FEATURES

- M-420iA and M-421iA are the intelligent packing robots which contribute for robotization of packing system.
- Two types of axis configuration are available.  
FANUC Robot M-420iA : 4 axis type  
FANUC Robot M-421iA : 2 axis type
- M-420iA and M-421iA can handle up to 3000 cycles per hour. Payload capacity of max. 50 kg enables to handle multiple works at once. Throughput capacity is much improved.
- M-420iA and M-421iA are controlled by R-J3iC that is newest, high performance and having various intelligent functions.

## 应用系统

### Example of an application system



将瓶子装入瓶箱的装箱系统  
Packing system of bottles into cases

# FANUC Robot M-420iA/421iA

动作区域 Operating Space

机器人的运动 Robot Motion

M-420iA

M-420iA

M-421iA

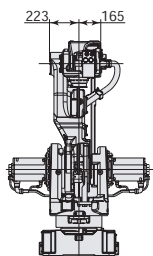
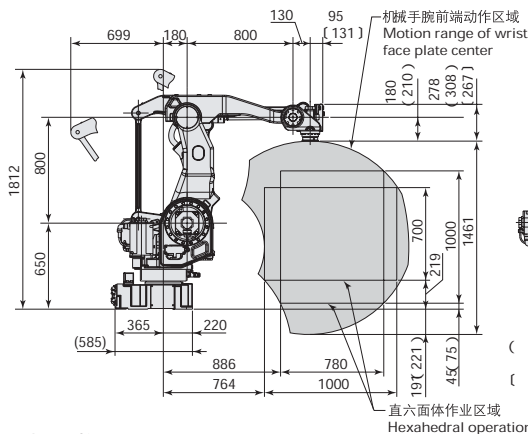
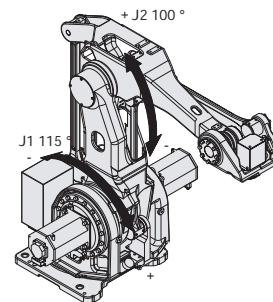
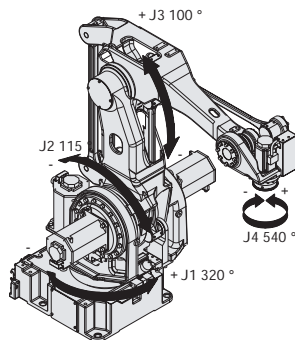
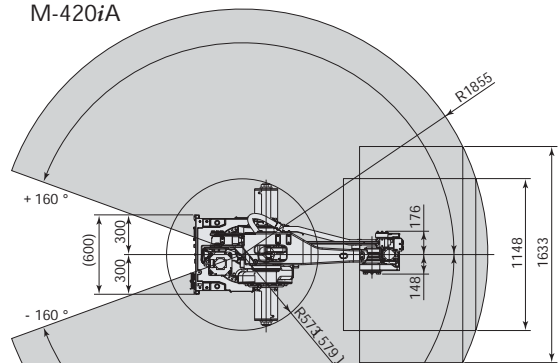

( ) : M-420iA 高速机械手腕规格  
High speed wrist type  
( ) : M-420iA 食品包装规格  
2nd Food type

M-421iA

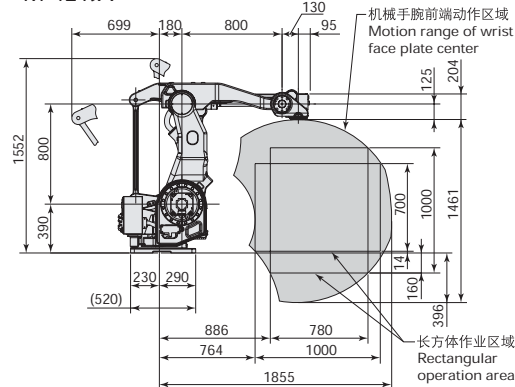

## 规格 Specifications

| 项目 Item                                       |         | 规格 Specifications   |   |         |
|---|---------|---|---|---------|
|   |         | M-420iA   | M-420iA 高速机械手腕规格<br>High speed wrist type | M-421iA |
| 动作形态 Type                                     |         | 多关节型机器人 Articulated type  |   |         |
| 控制轴 Controlled axes                           |         | 4轴 4 axes (J1, J2, J3, J4)  |   |         |
| 设置条件 Installation                             |         | 地面设置 Floor mount  |   |         |
| 机械手腕部可搬运重量<br>Maximum load capacity at wrist  |         | 40kg  | 30kg                                      | 50kg    |
| 有效范围 Reach                                    |         | 1855mm  |   |         |
| 最大动作速度<br>Maximum speed                       | J1      | 3.14rad/sec (180 deg/sec)   |   | —       |
|   | J2 (J1) | 3.49rad/sec (200 deg/sec)   |   |         |
|   | J3 (J2) | 3.49rad/sec (200 deg/sec)   |   |         |
|   | J4      | 6.11rad/sec (350 deg/sec)   | 12.6rad/sec (720 deg/sec)                 | —       |
| 机械手腕允许负载惯量<br>Allowable load inertia at wrist |         | 2.5kgm <sup>2</sup>   |   |         |
| 位置反复精度 Repeatability                          |         | ±0.5mm  |   |         |
| 机构部重量 Mass of mechanical unit                 |         | 620kg   | 630kg                                     | 520kg   |
| 设置条件 Installation environment                 |         | 环境温度 : 0~45度<br>环境湿度<br>通常 : 在75%RH或以下 注释1)<br>短期 (1个月之内) : 在95%RH或以下<br>振动值 : 0.5G或以下<br>Ambient temperature : 0 ~ 45<br>Ambient humidity<br>Normally : 75%RH or less Note 1)<br>Short term (within 1 month) : 95%RH or less<br>Vibration : 0.5G or less |   |         |

注释1) 不应有结露现象。

注释2) M-420iA 还备有食品包装规格。

Note 1) No dew, nor frost is allowed. Note 2) 2nd Food type is available for M-420iA

# FANUC LTD

Oshino-mura, Yamanashi 401-0597, Japan Phone: 81-555-84-5555 Fax: 81-555-84-5512  
http://www.fanuc.co.jp

北京发那科机电有限公司  
上海发那科机器人有限公司  
大同發那科自動化股份有限公司  
FANUC MECHATRONICS (MALAYSIA) SDN. BHD.

中华人民共和国北京市海淀区上地信息产业基地信息路9号 邮编: 100085  
中国上海市浦东新区金桥开发区金豫路500号 邮编: 201206  
台北市中山區104-35中山北路三段廿二號  
No.32, Jalan Pengacara U1/48, Temasya Industrial Park, Section U1, Glenmarie,  
40150 Shah Alam, Selangor Darul Ehsan, Malaysia  
No.1 Teban Gardens Crescent, Singapore 608919, Singapore  
香港九龍尖沙咀廣東道廿八號太陽廣場717室

电话: 86-10-6298-4739 传真: 86-10-6298-4741  
电话: 86-21-5032-7700 传真: 86-21-5032-7711  
电话: 886-2-2592-5252 传真: 886-2-2592-8124

Phone: 60-3-7628-0110 Fax: 60-3-7628-0220  
Phone: 65-6567-8566 Fax: 65-6566-5937  
电话: 852-2375-0026 传真: 852-2375-0015

● 本机的外观及规格如需改良而变更, 恕不另行通知。  
● 严禁擅自转载本商品目录中的内容。  
● 本说明书中所载的产品受《外汇和外国贸易法》的管制。从日本出口到其他国家时, 必须得到日本政府的出口许可。此外, 将该产品再出口到其他国家时, 必须得到再出口该产品的国家的政府许可。另外, 该产品还同时受美国政府的再出口限制。在出口或再出口该类商品时, 请向FANUC (发那科) 公司洽询。

● All specifications are subject to change without notice.  
● No part of this catalog may be reproduced in any form.  
● The products in this catalog are controlled based on Japan's "Foreign Exchange and Foreign Trade Law". The export from Japan may be subject to an export license by the government of Japan. Further, re-export to another country may be subject to the license of the government of the country from where the product is re-exported. Furthermore, the product may also be controlled by re-export regulations of the United States government. Should you wish to export or re-export these products, please contact FANUC for advice.

© FANUC LTD, 2006  
M-420iA(C)-01, 2006.3, Printed in Japan